

NTR Cars Size 1 - 2 and 3

Size 1 Uprand Cup Detail

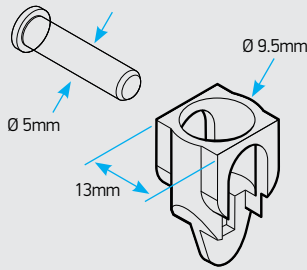

Size 1 upstand fits the following blocks:

- 60 synchro blocks
- 50 HTX blocks

Size 2 Uprand Cup Detail

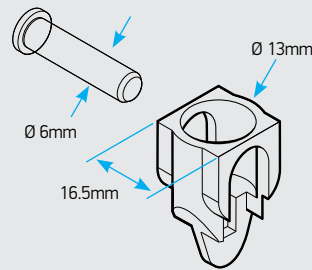

Size 2 upstand fits the following blocks:

- 72 synchro blocks
- 60 HTX blocks
- 60 / 60HL and 80 Racing blocks

Size 3 Uprand Cup Detail

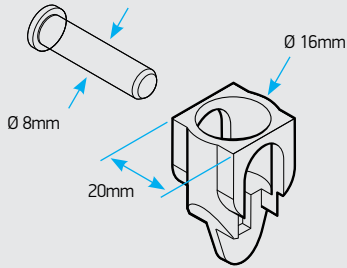

Size 3 upstand fits the following blocks:

- 90 synchro blocks
- 72 HTX blocks
- 80HL Racing blocks

Size 3 HL Uprand Cup Detail

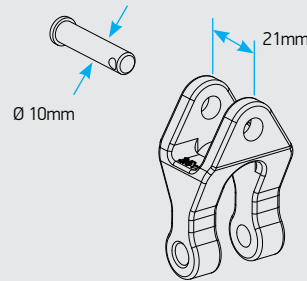

Size 3 upstand fits the following blocks:

- 105 synchro blocks
- 90 HTX blocks
- 105 Racing blocks

NTR Torlon Ball (TB) Mainsheet Cars Size 1, 2 and 3

TB Short Car with Shackle



PART NO	SIZE	WORKING LOAD LIMIT		LENGTH		WIDTH		WEIGHT	
		kg	lb	mm	in	mm	in	g	oz
29421300BK	1	600	1329	107	4 3/16	71	2 3/4	228	8.00
29422300BK	2	1100	2420	140	5 1/2	92	3 5/8	386	13.6
29423301BK	3	2000	4400	150	5 15/16	88	3 1/2	680	24.0

TB Short Car with Upstand



PART NO	SIZE	WORKING LOAD LIMIT		LENGTH		WIDTH		WEIGHT	
		kg	lb	mm	in	mm	in	g	oz
29421400BK	1	600	1329	107	4 3/16	71	2 3/4	241	8.50
29422400BK	2	1100	2420	140	5 1/2	92	3 5/8	397	14
29423400BK	3	2000	4400	150	5 15/16	88	3 1/2	781	27.3

TB Car with Shackle



PART NO	SIZE	WORKING LOAD LIMIT		LENGTH		WIDTH		WEIGHT	
		kg	lb	mm	in	mm	in	g	oz
29431300BK	1	900	1980	162	6 3/8	71	2 3/4	313	11.0
29432300BK	2	1500	3300	210	8 5/16	92	3 5/8	639	22.5
29433300BK	3	2500	5500	215	8 1/2	88	3 1/2	924	32.3

TB Car with Upstand



* 29432420 fitted with size 3 upstand

PART NO	SIZE	WORKING LOAD LIMIT		LENGTH		WIDTH		WEIGHT	
		kg	lb	mm	in	mm	in	g	oz
29431400BK	1	900	1980	162	6 3/8	71	2 3/4	364	12.8
29432400BK	2	1500	3300	210	8 5/16	92	3 5/8	767	27
29432420BK*	2*	2000	4400	210	8 5/16	92	3 5/8	839	33
29433400BK	3	2500	5500	215	8 1/2	88	3 1/2	743	26.0