

Base for pull-out poles

Code 13.440.10
Base with AISI 316 stainless steel cap.

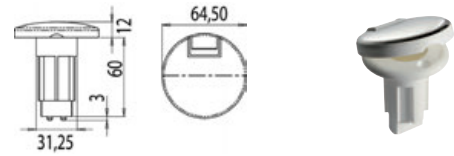

Flat base for retractable rods

FLUSH

AISI316 stainless steel base with cover. Rotate to open.
Minimum space required in height and width.
Can be installed either flush or flat.

Code	mm	Overhang mm	No of contacts
11.000.27	56x64x31	6	2

OSCULATI



Watertight LED surface light

IP66

High-efficiency SMD-HD LED light source. Version with radiated base through soft silicone seal, **ideal for boom, roll bar inflatables** etc. For pipes with a maximum diameter of 40 mm.

Code	Finishing	V	W	Switch	lu-men	Lux at 50 cm	K	LED beam angle	No of LEDs	mm	LED
13.192.20	white	12	3	Yes	450	342	4000	50°	10 SMD-HD	320x40x15 h	10 SMD-HD

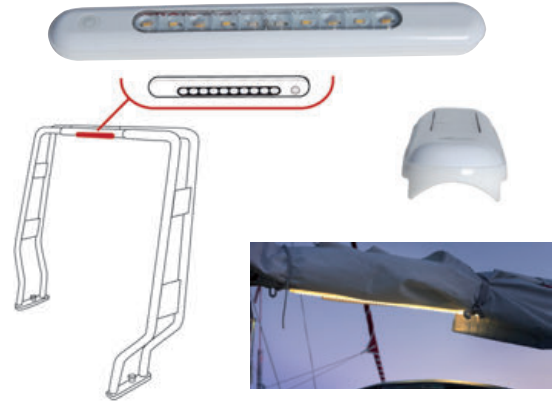
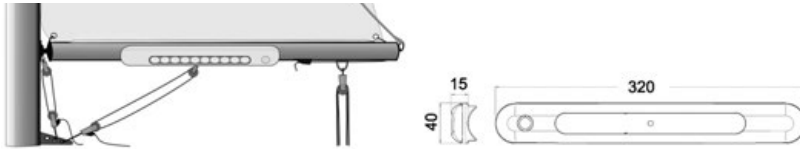

Battery-powered Bimini top light

MAGNETIC

WITH BATTERY

LED strip light with magnetic clip.
With the new magnetic fastening system, the strip light can be mounted in any position of the Bimini top. The clip is small and can be left on the Bimini top even when it's folded. The LED light is fitted with a long-duration battery (up to 12 hours), a light intensity control, a battery level indicator and a motion sensor for temporary switching on.
The LED light has a battery with a duration up to 12 hours, a control to adjust the light intensity, a battery level indicator, and a motion sensor for temporary activation.
Rechargeable with USB cable. Protection grade IP20

Code	V	W	lumen	K	LED	No of LEDs	Battery
13.195.12	5	2	150	6000	white	60	1300 mAh

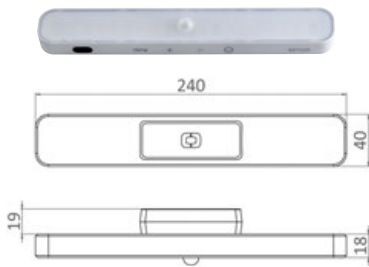

OSCULATI

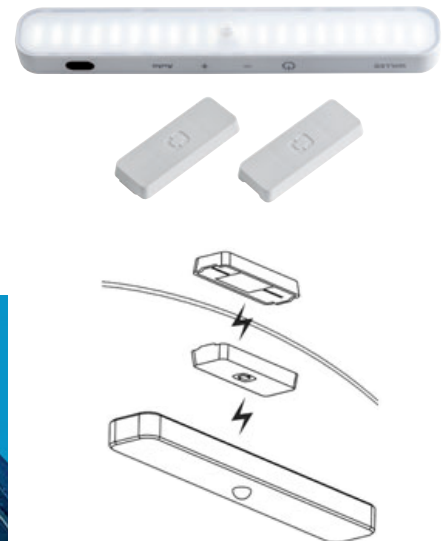

BIMINI compact overhead LED light

IP65/67

LED

Made of polished stainless steel, technopolymer glass. Recessless mounting.

Code	Bottom	V	W	Switch	Lux	IP	K	LED beam angle	No of LEDs	mm
13.525.01	flat	12/24	1.8	no	220	67	3000	25°	8 HD	102x33x11 (h)
13.525.02	flat	12/24	1.8	Yes	220	65	3000	25°	8 HD	102x33x11 (h)
13.525.04	Soft curved bottom for mounting on 35/50-mm Ø A-frame tubes	12/24	1.8	Yes	220	65	3000	25°	8 HD	104x35x15 (h)



OSCULATI

